

**510nm~520nm 20mW~30mW Coaxial Pigtailed LD with MMF | Built-in Photodiodes**
**520nm Fiber Coupled Laser Diode with 50um 60um 105um MM Fiber | With PD**

WSLP-520-030m-M-PD

Wavespectrum Laser Group

[www.wavespectrum-laser.com](http://www.wavespectrum-laser.com)

520nm Pigtailed Diode Laser		Wavespectrum Laser Group	
PARAMETER	SYMBOL	VALUE	UNIT
Reverse Voltage	$V_r$	2.0	V
Operating Temperature	$T_{op}$	-10~+60	°C
Storage Temperature	$T_{stg}$	-40~+85	°C
Lead soldering temperature (10 sec.)	$T_{is}$	260	°C
<b>Features:</b> <ul style="list-style-type: none"> <li>🔸 520nm</li> <li>🔸 Multi-mode Fiber</li> <li>🔸 Coaxial Package</li> <li>🔸 Built-in Photodiode</li> </ul>			
<b>Applications:</b> <ul style="list-style-type: none"> <li>🔸 Medical laser treatment</li> <li>🔸 Others</li> </ul>			
<b>Specifications</b>	<b>WSLP-520-030m-M-PD</b>		
	Min	Type	Max
Center Wavelength@25°C	510nm	520nm	530nm
Spectral Width (FWHM)	----	2.0nm	----
Output Power	20mW	----	30mW
Fiber Type	Multimode		
Fiber Core	62.5um (50um, 105um Optional)		
Monitor Current	----	100uA	----
Recommend Operating Temperature	25°C		
Fiber Connector	FC/SC/SMA905		
Fiber Length	----	80cm	100cm
Threshold Current (Typ.)	----	50mA	80mA
Operating Current (Typ.)	----	160mA	180mA
Operating Voltage	----	7.5V	8.0V
Package Style	Coaxial		
Photodiode	Built-in		



### Coaxial Package View

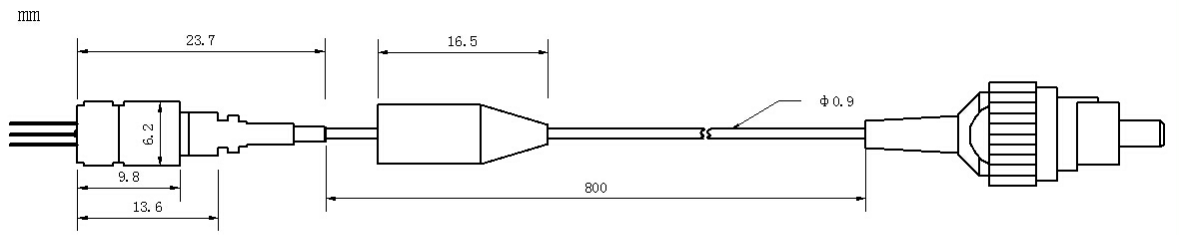

### PIN Bottom View:

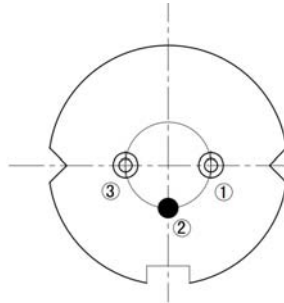

1	LD(-)
2	LD(+)&PD(-)
3	PD(+)

Electrically shorten LD module and store in non-extreme conditions.  
 Suggest using the constant current power supply.



Wavespectrum Laser Group  
[www.wavespectrum-laser.com](http://www.wavespectrum-laser.com)  
[sales@wavespectrum-laser.com](mailto:sales@wavespectrum-laser.com)

